

APPLICATION FOR A PERMIT TO CONSTRUCT A WATER WELL IN THE UPPER ELKHORN NATURAL RESOURCES DISTRICT

1. LANDOWNER INFORMATION

NAME: _____
 ADDRESS: _____
 PHONE: (____) - _____
 Contact other than Landowner _____
 Address & Phone _____

DWEE AND NRD USE ONLY

Late Permit Paid Compliant
 Permit No. UE- _____
 Registration No. _____
 Chemigation No. _____
 GPS _____
 Acre Expansion/Transfer #: _____

2. PURPOSE OF WELL New Well Supplemental Well Acre Expansion/Transfer

TYPE (check one)

Irrigation Domestic Livestock Public Water Supply Dewatering (over 90 days)
 Geothermal Ground Heat Exchanger Commercial / Industrial Recovery Ground Water Source
 Heat Pump Monitoring Aquaculture Other (specify) _____

3. LOCATION OF THE PROPOSED WELL

_____ County, Section _____ Subsection _____
 Township _____ North, Range _____ West

The well will be located _____ feet from the North South section line, and will be _____ feet from the East West section line. *Please attach aerial photo, if available.*

The box at the right represents a one square mile section. Please indicate in this box: the proposed location of the well with an "X", and the proposed location of the water use area by outlining the area. If the water is to be used outside of the above written legal description, give the legal description of this area : _____ County, Township _____ North, Range _____ West, Section _____ Subsection _____

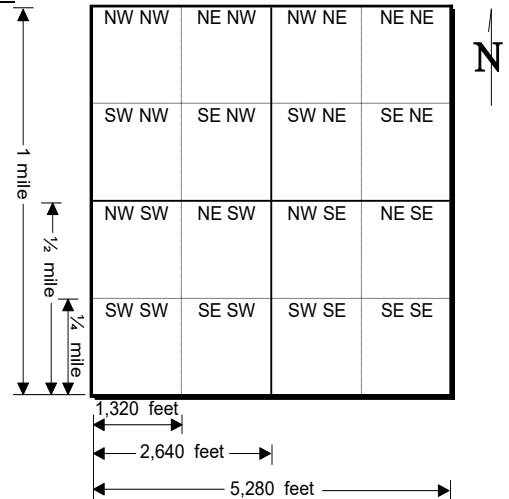

4. IRRIGATION WELL INFORMATION - FLOWMETER IS REQUIRED

How many acres will be irrigated? _____ Acres.
 What type of irrigation system is planned? Center Pivot Gravity Other (specify) _____
 What type of power supply will be used for the well? Electricity Fuel - type? _____
 Will the well be used in a system with other wells? Yes No If yes, list well reg #(s): _____
 Will fertilizer, chemicals, or animal waste be applied through the irrigation system? Yes No

5. REPLACEMENT WELL AND WELL ABANDONMENT INFORMATION

Is this a replacement well? Yes No If no, please proceed to section 6. The following questions are for replacement wells only.
 Registration number of the well to be replaced: _____. Date well to be replaced was last operated _____
 Replacement well will be _____ feet from the original well. Original well was decommissioned _____
 Will the water use area of the new well be the same area as the decommissioned well? Yes No

6. EXPECTED SPECIFICATIONS OF THE WELL AND PUMP (Please attach test hole log, if available)

Approximate date when construction will begin: _____, 20____.
 Estimated pump column diameter: _____ inches. Estimated total depth of the well: _____ feet.
 Estimated pumping capacity: _____ gallons per minute. Estimated well casing diameter: _____ inches.
 Well Driller: _____ Address: _____ Phone: _____

7. I certify that I am familiar with the information contained in this application, and its restrictions, rules, and regulations, and that to the best of my knowledge and belief such information is true, complete, and accurate.

This form must be completed in full and be accompanied by a nonrefundable, \$50.00 filing fee (payable to the Upper Elkhorn Natural Resources District), and submitted to the District at the address listed on the back of this form.

Date _____ Landowner Signature _____

Date Approved _____ NRD Representative _____

The Permit to Construct A Water Well Is Non-Transferable.

Due to LB962 adoption in 2004, this well permit alone does not guarantee landowner construction of a new well. Upon DWEE designation of "Fully Appropriated" a stay will be enforced on all new permits and expansion of new irrigated acres in the District. This stay may be lifted upon development of the integrated Management Plan.

SEE OTHER SIDE FOR IMPORTANT PERMIT RESTRICTIONS, RULES AND REGULATIONS

This form must be completed in full and be accompanied by a nonrefundable, \$50.00 filing fee (payable to the Upper Elkhorn Natural Resources District), and submitted to the District at the address listed below:

Upper Elkhorn Natural Resources District

301 N. Harrison

O'Neill, NE 68763

Phone: (402) 336-3867

Fax: (402) 336-1832

Please fill out the application completely and correctly. An incomplete or defective application will be returned to the applicant. Corrections must be submitted to the NRD within 60 days or the application will be canceled. The District will either issue the permit with conditions attached, or deny the permit, no later than 30 days after receipt of a complete and properly prepared application and application fee.

PERMIT RESTRICTIONS

1. Well permits are required prior to construction or a late fee of \$250 will be assessed.
2. Permits are not required for wells designed to pump 50 gallons per minute or less, test holes, or dewatering wells with an intended use of 90 days or less; unless the well(s) are comingled wells with a combined capacity of 50 gallons per minute or more.
3. A permit must be obtained for an existing well that previously did not require a permit but will be modified into a well for which a permit is required as defined in the District's rules and regulations.
4. If construction of the well is not complete within one year of permit approval, a new permit will be required and the previous permit will be cancelled.
 - a. All Water Well Applications for Expansion of Acres and Transfers will have until October 1 to be completed.
5. The well authorized by this permit must comply with well spacing requirements set forth by state statutes and any further spacing requirements set forth by the District. A flowmeter is also required on all new wells.
 - a. Replacement wells can only irrigate certified groundwater irrigated acres within the Upper Elkhorn NRD.
6. Water wells to be constructed within 50 feet of a bank of a channel of a stream must have a surface water right for that stream from the Nebraska Department of Water, Energy, and Environment before construction of the well.
7. Any person who commences or causes construction of a well for which the required permit has not been obtained, or who knowingly furnishes false information regarding such permit, shall be guilty of a Class IV misdemeanor.
8. This permit does not register the well with the Nebraska Department of Water, Energy, and Environment. All wells are required to be registered with the Nebraska Department of Water, Energy, and Environment by the water well contractor (or by the water well owner if the owner constructs the well) within 60 days after the well is completed.
9. An offset of any new consumptive use may be required by the landowner if the well is constructed after the DWEE determines that the portion of the District where the well will be located is fully appropriated.
10. If the well is constructed after the date that an integrated management area is adopted by the District, it may be subject to additional rules and regulations

ADDITIONAL COMMENTS AND/OR RESTRICTIONS: _____

If possible, please mark the proposed well site with a flag